

RINGSCHRAUBE_EYE BOLT

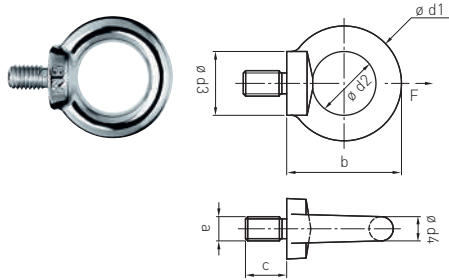

Artikelnummer Part number	a	b	c	ø d1	ø d2	ø d3	ø d4	MBK (kN)	F (kg)
837-0600-01*	M6	28	12	28	16	17	6	-	-
837-0600	M6	36	13	36	20	20	8-11	-	-
837-0800-01*	M8	36	13	36	20	20	8	-	-
837-0800 dwg	M8	36	13	36	20	20	8-11	8,2	140
837-1000-01*	M10	45	17	45	25	25	10	-	-
837-1000 dwg	M10	45	17	45	25	25	10-13	13,5	230
837-1200-01*	M12	53	21	54	30	30	12	-	-
837-1200 dwg	M12	53	21	54	30	30	12-15	20,0	340
837-1600 dwg	M16	62	27	63	35	35	14-17	41,2	700
837-2000 dwg	M20	71	30	72	40	40	16-19	70,6	1200
837-2400 dwg	M24	90	36	90	50	50	20-24	105,9	1800

Werkstoff 1.4401 | DIN 580 | geschmiedet
 *Ähnlich DIN 580 | gegossen und poliert
 MBK= Mindestbruchkraft
 F = Tragfähigkeit

Material AISI316 | DIN 580 | drop-forged,
 *casted and mirror polished
 MBK= Breaking load
 F = Working load limit

ALLE ANGABEN IN MILLIMETERN_ALL DIMENSIONS IN MILLIMETRES